

PITMEC

THE PCON-E 660 CONCENTRIC UNDERREAMING SYSTEM



CASING SIZE 711MM OD X 686MM ID DRILLING DIA. 735MM

PNEUMEC PCON-E 660 CONCENTRIC UNDERREAMING SYSTEM

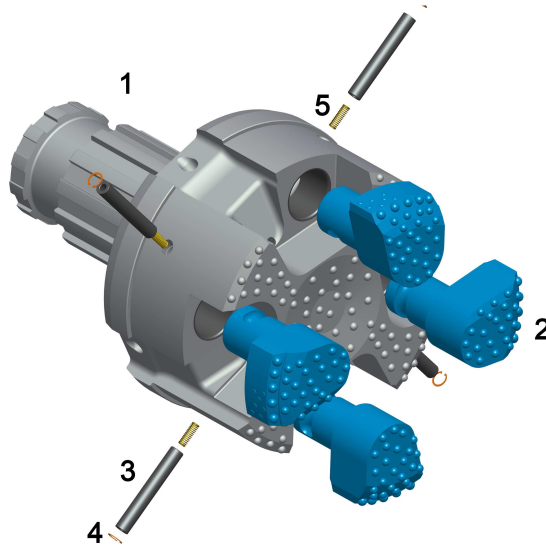

PCON-E 660 PARTS LIST

| | | |
|----|-----------------------|--------------|
| 1. | DRIVER BIT N240 SHANK | UGD660N24PCE |
| 2. | REAMER (4) | UBS660PCE |
| 3. | LOCKING PIN (4) | USP66050PCE |
| 4. | CIRCLIP (4) | USP66053PCE |
| 5. | SPRING (4) | USP66054PCE |
| 6. | COMPLETE SYSTEM | UCS660N18PCE |

PCON-E 660 SPECIFICATIONS

| | | | |
|---------------------|-------|-----------------|---------------------|
| UPPER BODY DIAMETER | 680MM | CLOSED DIAMETER | 660MM |
| REAMING DIAMETER | 735MM | CASING SIZE | 711MM OD X 686MM ID |
| SYSTEM LENGTH | 925MM | SYSTEM WEIGHT | 1140KG |

PCON-E 660 CASING SHOES

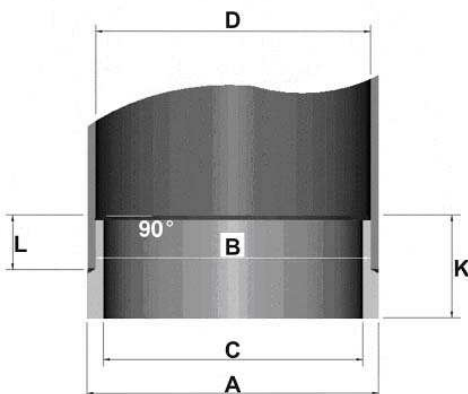

| | |
|--------|-------|
| DIA. A | 711MM |
| DIA. B | 683MM |
| DIA. C | 663MM |
| DIA. D | 686MM |
| L | 80MM |
| K | 145MM |

PNEUMEC

PNEUMEC COMPANY LIMITED

1st Floor, Tin On Sing Comm. Bldg., 41-43 Graham St. Central, H.K.

Tel : (852) 2180 9922

Fax : (852) 2180 9982

Website : www.pneumec.com

email : info@pneumec.com